



3745 Communication Controller Models A
3746 Expansion Unit Model 900
3746 Nways Multiprotocol Controller Model 950

SY33-2125-01

**Service Processor
Installation and Maintenance
(Based on 6275)
Addendum
EC F70099**

These revised pages are intended to replace the equivalent pages in the current version of the *Service Processor Installation and Maintenance (Based on 6275)*, SY33-2125-01. The pages affected are pages: 1-25, 1-26, 5-17 and 5-18.

Step 12. ____ Connect the 25-pin V.24 cable from the DTE to the 25-pin connector on the modem rear panel. Fasten the connector retaining screws.

Step 13. ____ Set the modem power switch to ON. Wait until the modem operational message is displayed on the operator panel (about 15 seconds).

If the modem is connected to an asynchronous DTE which can send AT commands to the modem, you can use the DTE to configure the modem to match your communication system requirements. Otherwise, the modem can be configured through the operator panel, refer to "Setting the 7858 Connected to the COM1 Connector (ASYN)"

Note: Ten factory Redefined modem configurations are available. You could retrieve the factory configuration which better matches your system requirements, make any further configuration adjustment you should require, and save your modem configuration in one of the ten user configuration slots.

Step 14. ____ Now the modem is ready for operation. You can try it with your system. If you observe a basic system problem, such as the DTE not being able to send commands to the modem successfully, verify again that your individual modem configuration parameters are matching your system requirements.

If you have a problem because the dialing tone is not provided by your PBX or exchange set the modem as follow:

- Power OFF the modem
- Power ON the modem while you are pushing the **Enter** key at the same time. Release the **Enter** key when the message: DATAPUMP TEST is displayed.

After this, the modem performs the dial through the switchboard without looking for dial tone (Blind dial ATX1). This setting is maintained even if the modem is powered OFF and ON again.

Step 15. ____ If you have a problem while using the modem, see "Problem Determination" chapter in the *IBM 7858 Professional Modem Guide to Operation*, GA13-1981.

Setting the 7858 Connected to the COM1 Connector (ASYN)

1. ____ Power OFF the modem
2. ____ Press and hold the ↑ key while power ON the modem.
3. ____ The modem is set to Factory 0 in AT command mode.

Saving the Configuration of the 7858

If you want to save the configuration just defined, in order to have it loaded again at the next modem reset, perform the following steps:

1. ____ Press the ↓ key until the "CONFIGURATIONS" message displayed the top row.
2. ____ Press the → key until the "Store User Conf." message displayed the bottom row.
3. ____ Press the ENTER key select the option.

4. ____ Pressing the ↑ key, select the User Configuration Location where the current modem configuration must be saved (0 to 9).
5. ____ Press the ENTER key save the current modem configuration.
6. ____ The defined configuration now active and saved.

Now every time the modem is reset (power on), the last user configuration which was saved is loaded as the current modem configuration.

Connecting the 7858

1. ____ **Plug** the cable (PN 782984) into slot 3 **1** of the Service Processor. The drawer and slide kit (PN 58G5698) are always shipped, but are not used if the expansion frame is not installed.
2. ____ On the modem's rear panel, **plug** the other cable lead into the 25-pin connector **2**.

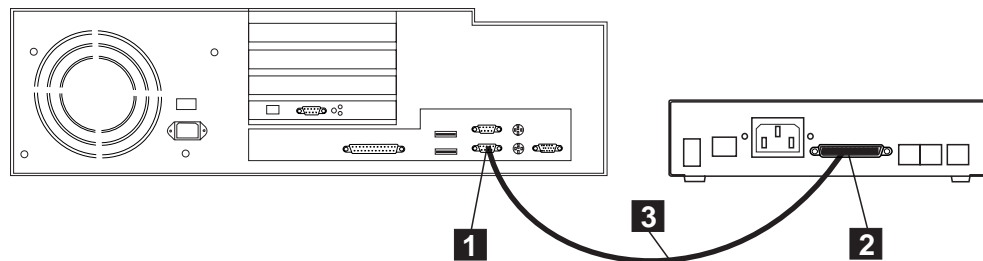

Figure 1-23. Connecting the Service Processor (6275) from COM1 to the 7858

If you received a **controller expansion**, go to **step 3**, otherwise go to “Step 5 - Customizing Your Service Processor” on page 1-33.

3. ____ Slide the 7858 in the controller expansion as shown in Figure 1-24.

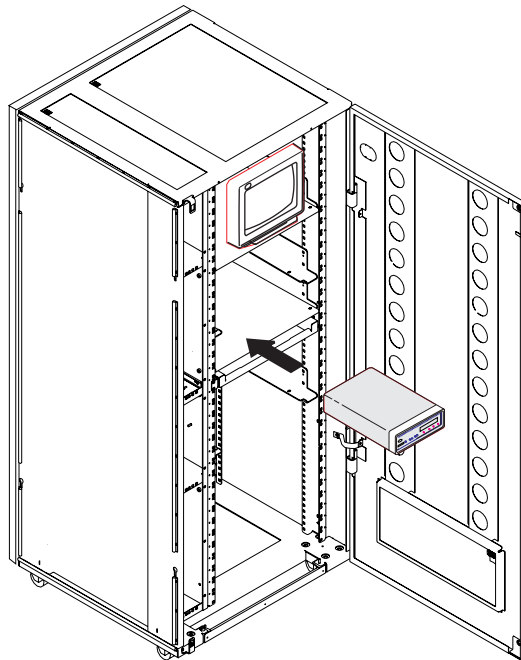

Figure 1-24. Installing the 7858 in the Controller Expansion

Go to “Step 5 - Customizing Your Service Processor” on page 1-33 .

```

Change Configuration Parameters
Adapters Mode | Plug and Play | Other Parameters

Select each mode for a detailed description

Adapter Modes
- Enhanced Modes
- Auto 16 Mode
- ISA 16 Mode

OK          Cancel    Help

```

8. Using the **Up** and **Down** keys select the **ISA 16 Mode** (note that the response time is very slow) then press simultaneously **Alt** and **P** keys to select the **Plug and Play** window.

9. The following window is displayed.

```

Change Configuration Parameters
Adapters Mode | Plug and Play | Other Parameters

Make any Changes to the configuration, then select <OK>

- Plug and Play Automatic Configuration
- Manual (locked) Configuration for Plug and Play systems
- Manual Configuration for no Plug and Play (legacy) systems

OK          Cancel    Help

```

10. Select the **Manual (locked) Configuration for Plug and Play systems**, using the tab key select **Interrupt**, and using the arrow key, select interrupt: **7**

11. Press simultaneously the **Alt** and **R** keys.

12. The following window is displayed.

```

Change Configuration Parameters

Remote IPL                                Data Rates
o Enable                                  o 16 Mbps
o Disable                                 o 4 Mbps

Auto Sense                                Bus Wide
o Enable                                  o 16 Mbps
o Disable                                 o 8 Mbps

OK          Cancel    Help

```

13. Using the **Up**, **Down**, and **Tab** keys select:

- Remote IPL: **Disable**

- Data Rates: **16 Mbps**
- Auto Sense: **Disable**
- Bus Wide: **16 bits**

Select **OK** and press **Enter**.

14. The following window is displayed.

View Adapter Configuration

Configurable	Hardware
Select <Suggest> or <Change> to make changes to the configuration below Then press <Store> to store these changes to the adapter.	
Mode	ISA 16
Remote IPL:	Disabled
Data Rate:	16 MBps
Auto Sens	Disabled
Bus Width	16 bits
Adapter Plug and Play	Manual (legacy)
Interrupt:	7
I/O Address:	A20-A23
ROM Address	CA000-CBFFF
RAM Address	C8000-C9FFF
<div style="display: flex; justify-content: space-around; margin-top: 10px;"> Suggest Change Defaults Store </div> <div style="display: flex; justify-content: space-around; margin-top: 5px;"> Done Cancel Help </div>	

15. Using the **Up** and **Down** keys select the **Store**, then press **Enter**.

16. The adapter configuration is stored. Wait until the following window is displayed.

Storing Configuration

The adapter configuration settings that you have chosen are now stored.

NOTE: Changes made to the adapter do not become effective until your computer is powered OFF and back ON: A reboot will not activate the changes.

OK

17. Press **Enter**.

18. The following window is displayed.

View Adapter Configuration

Configurable	Hardware
Select <Suggest> or <Change> to make changes to the configuration below Then press <Store> to store these changes to the adapter.	
Mode	ISA 16
Remote IPL:	Disabled
Data Rate:	16 MBps
Auto Sens	Disabled
Bus Width	16 bits
Adapter Plug and Play	Manual (legacy)
Interrupt:	7
I/O Address:	A20-A23
ROM Address	CA000-CBFFF
RAM Address	C8000-C9FFF
<div style="display: flex; justify-content: space-around; margin-top: 10px;"> Suggest Change Defaults Store </div> <div style="display: flex; justify-content: space-around; margin-top: 5px;"> Done Cancel Help </div>	

19. If not selected, using the **Tab** key, select **Done**, then press **Enter**.